

ADDENDUM NO. 1

ISSUE DATE: 2/5/2026
FSCJ ITB NUMBER: 2026C-24
FSCJ ITB TITLE: Wayfinding Monument Entrances at Various locations at South Campus

The above numbered solicitation is amended as follows:

- Attachment "A" Clarifications, Questions and Answers
- Attachment "B" On-Site Attendance Sign-In from Public Pre-Bid Meeting held on 2/4/2026 @ 10:00 a.m. (Includes Site Visit Attendance)
- Attachment "C" On-Site Pick-up Plan Holders List at 2/4/2026 Pre-Bid Meeting
- Attachment "D" GetAll Solicitation Holders List a.k.a. Plan Holders List (As of 2/4/2026)
- Attachment "E" REPLACEMENT Solicitation Drawing Pages: Cover, LD1.02, LS1.02, LS2.02, LS2.03, and LS2.04 (a separate document "2026C-24 Addendum 1 Attach E")

The hour and date specified for receipt of bids:

X is not extended, remains: **February 26, 2026 at 2:00 p.m.**
_____ is extended until: _____
_____ posting date is extended until: _____

Except as provided herein, all terms and conditions of the solicitation, including changes made by all prior addenda (if any), remain unchanged and in full force and effect.

Bidders must acknowledge receipt of this addendum prior to the time set for receipt and opening of bids as specified in the solicitation, or as amended, by one of the following methods:

- (a) By signing and returning one copy of this addendum.
- (b) By acknowledging receipt on the copy of the bid submitted.

FAILURE TO ACKNOWLEDGE RECEIPT OF THIS ADDENDUM PRIOR TO THE HOUR AND DATE SPECIFIED MAY RESULT IN REJECTION OF YOUR OFFER. If, by virtue of this addendum, you desire to change an offer already submitted, such change may be made by letter, provided such letter makes reference to the solicitation and this addendum and is received prior to the opening hour and date specified.



Randi Brokvist
Executive Director of Purchasing

(Complete this portion)

TO BE RESPONSIVE ALL BIDDERS MUST ACKNOWLEDGE RECEIPT OF ADDENDUM #1

COMPANY: _____

SIGNATURE: _____

TITLE: _____

DATE: _____

ADDENDUM NO. 1

CLARIFICATIONS

1. The Question Deadline is 2/12/2026 at 5:00 p.m.
2. Bidders are to utilize the Attachment "E" REPLACEMENT Solicitation Drawing Pages: Cover, LD1.02, LS1.02, LS2.02, LS2.03, and LS2.04 (separate document "2026C-24 Addendum 1 Attach E") included with the Addendum #1 for construction and bidding purposes.



QUESTIONS AND ANSWERS

No questions submitted as of 2/5/2026.

Pre-Bid Conference Sign-in Sheet
ITB #2026C-24: Wayfinding Monument Entrances at Various locations at South Campus

Date of Pre-Bid Meeting: February 4, 2026Time and Location: 10:00 a.m., South Campus, Bldg. M1, Room M1140Page 1 of 5

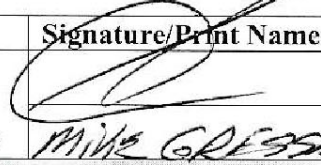
NOTE: Please Print

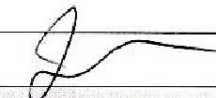
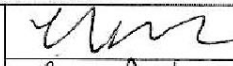
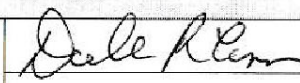



Company Name	Address/City, ST Zip code	Telephone #	Fax #	Email Address	Signature/Print Name
STG CONTRACTING GROUP, INC.	115 LAND GRANT ST #6 ST AUG FL	904 287 9898	—	CLW@STG CONTRACTING GROUP.COM	 MIKE GRESSER
"	"	"	—	GS@STG CONTRACTING GROUP.COM	 GENE STATION
FASTSIGNS	2141 Sx Johns Bluff	904 724 7446	—	Jim.Cochran @fastsigns.com	
WELBRO Building Corporation	2301 Maitland Center Pkwy # 250	407-475- 0800	—	akerr@welbro.com	Austin Kerr Austin Kerr
FSCJ FACILITIES MAINT	11901 Beach Blvd Jax, FL 32246	904-646-2401		Donald.dykeman@ fscj.edu	 Ron Dykeman
FSCJ Facilities	501 West State St.	904-633-5973		Dale.Cason @fscj.edu	 Dale Cason

additional email

Pre-Bid Conference Sign-in Sheet
ITB #2026C-24: Wayfinding Monument Entrances at Various locations at South Campus

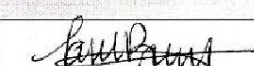
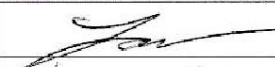
Date of Pre-Bid Meeting: February 4, 2026Time and Location: 10:00 a.m., South Campus, Bldg. M1, Room M1140Page 2 of 5

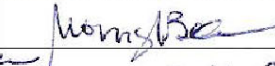
NOTE: Please Print

Company Name	Address/City, ST Zip code	Telephone #	Fax #	Email Address	Signature/Print Name
ACON Construction	3653 Regent Blvd 32224 Jacksonville Florida	904 864 6723	—	CMAC@alconci.com CMA@alconci.com	 Chase Anderson
Fastsigns		787-640-0316	—	tannya.burgos@ fastsigns.com	 Tannya Burgos
Dobson Electric	6925 West Beaver St Jax FL 32254	904-523-1597	—	Isolomon@ dobsonelectric.com	 Lance Solomon
FSCJ Facilities Dept	501 W. State Street JAX FL	904 742-5344		lisa.reimertson@ fscj.edu	 Lisa Reimertson
FSCJ Purchasing	501 W. State JAX FL 32202	904-632-3301		r.brookvist@ fscj.edu	 Rachel Brookvist
FSCJ FACILITIES	501 W State St JAX FL 32202	904 632 3244		Mbellicke@fscj.edu	 Marnie Bellicke
Atlantic Engineering Services	4141 Southpoint Dr E Suite C	904 743-4633		w.morgan@aesps.com	

Pre-Bid Conference Sign-in Sheet
ITB #2026C-24: Wayfinding Monument Entrances at Various locations at South Campus

Date of Pre-Bid Meeting: February 4, 2026Time and Location: 10:00 a.m., South Campus, Bldg. M1, Room M1140Page 3 of 5

NOTE: Please Print

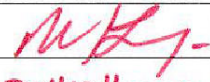
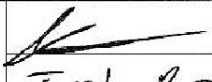
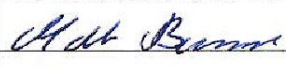
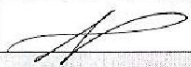
Company Name	Address/City, ST Zip code	Telephone #	Fax #	Email Address	Signature/Print Name
PRIME DE .	13901 SUTTON PARK. S. Suite 200 JACKSONVILLE FL 32224	904 739 3655		RICHARD. LONERGAN @PRIMEENG.COM	 RICHARD Loneragan.
Kim's electrc	13619 N. Main St Sax/ FL / 32218	904 -757-6633		Josh. Kins electrc@ comcast.net	 Josh Bruton
EVR		904-237 5747			 Mark Brench
EVR	1892 Deltair Blvd, Orange Park Florida, 32073	904-264-0123		aville.pennington@viviscarsconstruction.com	 Aville Pennington



Page 4 of 5

[illegible]

Pre-Bid Conference Sign-in Sheet
ITB #2026C-24: Wayfinding Monument Entrances at Various locations at South Campus

Date of Pre-Bid Meeting: February 4, 2026Time and Location: 10:00 a.m., South Campus, Bldg. M1, Room M1140Page 5 of 5

NOTE: Please Print

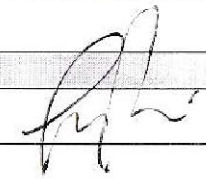
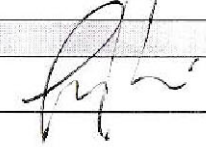
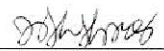
Company Name	Address/City, ST Zip code	Telephone #	Fax #	Email Address	Signature/Print Name
Vanguard Electric	3653 Regent Blvd	847 366 7076		Bpatterson @ VECTAX.COM	
	Ste 302 Jax 32224				Bryan Patterson
FASTSIGNS	FASTSIGNS	910-389-2368		GEOFFREY. KLEIN @ FASTSIGNS	GEOFFREY KLEIN
	St. Johns Bluff				
FASTSIGNS	2141 St Johns Bluff	904-716-9302		Patrick.pennell a) fastsigns.com	Patrick Pennell
	Jax 32246				
BIRKEN CONSTRUCTION	11747 Philips Hwy	(904) 518-6154	(904) 518-1119	SEAN @ BIRKENINC.COM	
	#301 JAX, FL 32256				
Precise Cabling Inc	8110 Cypress Pkwy	(904) 295-8860	(904) 295-8865	phil@precisecabling.com Justin@precisecabling.com	D. Justin GRIFFIN PHILIP GRIFFIN
	Drive #306 Jax, FL 32256				
Here Rentals	240 Hammond Blvd	904 931 4860		Joshua Sharkey @ HERERENTALS.COM	 Josh Sharkey
	Jacksonville				

Pre-Bid Site Visit Sign-in Sheet
ITB #2026C-24: Wayfinding Monument Entrances at Various locations at South Campus

Date of Pre-Bid Meeting Site Visit: February 4, 2026Time and Location: Directly Following Pre-Bid Meeting, South Campus, Bldg. M1, Room M1140Page 1 of 5

NOTE: Please Print

Company Name	Address/City, ST Zip code	Telephone #	Fax #	Email Address	Signature/Print Name
ALON Construction	3853 Regent 401 32224 Jacksonville Florida	904 864 5723	—	CMA@alconc.com	 Chase Anderson
LAKESIDE SIGN Company	105 N Beor Rd Denver NC	404-491 4709		WES.KAYE LAKESIDE SIGN COMPANY .com	 Wes Kaye
					 Austin Kerv

Date of Pre-Bid Meeting Site Visit: February 4, 2026Time and Location: Directly Following Pre-Bid Meeting, South Campus, Bldg. M1, Room M1140Page 2 of 5

NOTE: Please Print

Company Name	Address/City, ST Zip code	Telephone #	Fax #	Email Address	Signature/Print Name
PCI	8110 CYPRESS PLAZA DORSTE 306 JTA, FL 32256	904-295-8880		PHIL@PRECISE CABLETV.COM	 PHIL PRECISE

Date of Pre-Bid Meeting Site Visit: February 4, 2026Time and Location: Directly Following Pre-Bid Meeting, South Campus, Bldg. M1, Room M1140Page 3 of 5

NOTE: Please Print

Company Name	Address/City, ST Zip code	Telephone #	Fax #	Email Address	Signature/Print Name
Dobson Electric	6925 W Beaver	904-523-1597	—	lsolomon@ dobson electric .com	 Lane Solomon
					 Amy Young

Pre-Bid Site Visit Sign-in Sheet

ITB #2026C-24: Wayfinding Monument Entrances at Various locations at South Campus

Date of Pre-Bid Meeting Site Visit: February 4, 2026

Time and Location: Directly Following Pre-Bid Meeting, South Campus, Bldg. M1, Room M1140Page 4 of 5

NOTE: Please Print

Company Name	Address/City, ST Zip code	Telephone #	Fax #	Email Address	Signature/Print Name
STC CONTRACTS					
VANCOUVER ELECTRICAL					

Date of Pre-Bid Meeting Site Visit: February 4, 2026

Time and Location: Directly Following Pre-Bid Meeting, South Campus, Bldg. M1, Room M1140Page 5 of 5

NOTE: Please Print

Company Name	Address/City, ST Zip code	Telephone #	Fax #	Email Address	Signature/Print Name
BIKEN	11797 PHILIPS HWY	(904) 655-0206		SEAN@BIKENINC.COM	
CONSTRUCTION	#301 JAX FL				

Additional Plan Holders

TITLED: Wayfinding Monument Entrances at Various locations at South Campus

[illegible]

Solicitation: 2026C-24 - Wayfinding Monument Entrances at Various locations at South Campus

Company		Viewed On
Tim Young Construction, Inc.	tracy@timyoungconstruction.com	Monday, January 26, 2026
WELBRO	ssawyer@welbro.com	Monday, January 26, 2026
Elitetex LLC	program@governmentbuy.com	Monday, January 26, 2026
Tower Davis Construction, LLC	chuck@tower-davis.com	Monday, January 26, 2026
Lakeside Sign Company	wes.kaye@lakesidesigncompany.com	Monday, January 26, 2026
CGC INC	office@cgccivil.com	Monday, January 26, 2026
STG Contracting Group, Inc.	clw@stgcontractinggroup.com	Monday, January 26, 2026
LEGO Construction	snethi@legocc.com	Monday, January 26, 2026
Holman Inc	jcole@holman-inc.com	Monday, January 26, 2026
ACON Construction Co., Inc.	cwatson@aconcci.com	Monday, January 26, 2026
LEGO Construction CO.	nip@legocc.com	Monday, January 26, 2026
Marand Builders	malvarado@marandbuilders.com	Monday, January 26, 2026
Marand Builders	jjohnson@marandbuilders.com	Monday, January 26, 2026
Dominicus USA	mhernandez@dominicusrd.com	Monday, January 26, 2026
OLIVENCIO CNSTRUCTION LLC	olivenciojp@gmail.com	Monday, January 26, 2026
Outstanding Concrete Construction Services LLC	jamesjohnsonjr3@yahoo.com	Monday, January 26, 2026
SevenOutsource	rfpalerts@gmail.com	Tuesday, January 27, 2026
Southeastern Lighting Solutions and Signs Florida	izzie@southeasternlightingsolutions.com	Tuesday, January 27, 2026
Southeastern Lighting Solutions and Signs Florida	izzie@southeasternlightingsolutions.com	Tuesday, January 27, 2026
LEGO Construction Co.	mas@legocc.com	Tuesday, January 27, 2026
Birken Construction, Inc.	mo@birkeninc.com	Tuesday, January 27, 2026
i2 Visual, Inc.	john.hose@i2visual.com	Tuesday, January 27, 2026
Complete Signs	liz@completesigns.net	Tuesday, January 27, 2026
Franklin Bronze Plaques	audrey@franklinbronzeplaques.com	Tuesday, January 27, 2026
Prime Vendor Inc.	primevendor124@gmail.com	Tuesday, January 27, 2026
PWXPress	bids@pwxpress.com	Tuesday, January 27, 2026
Gratia	davidopoku@gogratia.com	Tuesday, January 27, 2026
Sun State Nursery and Landscaping, LLC	trey@sunstatenursery.com	Wednesday, January 28, 2026
Portal Genial Serv TI LTDA	licitaja@licitaja.com.br	Wednesday, January 28, 2026
Watchfire	hunter.orme@watchfire.com	Wednesday, January 28, 2026
ConstructConnect	ashley.welker@constructconnect.com	Wednesday, January 28, 2026
Visual	visualbalerts@gmail.com	Thursday, January 29, 2026
E. Vaughan Rivers, Inc.	arielle.pennington@riversconstruction.com	Friday, January 30, 2026
Priority One Sign	angelar@priority1sign.com	Friday, January 30, 2026
CC Borden Construction	ccborden@ccborden.com	Friday, January 30, 2026
SignCrafters	sales@signcraftersflorida.com	Friday, January 30, 2026
KBT Contracting Corp	info@kbtcorp.com	Friday, January 30, 2026
Catalyst Construction	nola@catalystcci.com	Friday, January 30, 2026

GetAll Solicitation Holders List a.k.a. Plan Holders List (As of 2/4/2026)**Attachment D (Continued)**

GFL	elliott@gfltrees.com	Friday, January 30, 2026
The Engineering Company	guillermmod@theengineeringco.com	Friday, January 30, 2026
BidJudge.com	az@bidjudge.com	Friday, January 30, 2026
EGX Group	spencer@egxgroup.com	Friday, January 30, 2026
Stewart Signs	jthrash@stewartsigns.com	Friday, January 30, 2026
Gtech	contracts@alliedsolutionenterprise.com	Monday, February 2, 2026
SIGNSTAR	angela.burney@signstar.net	Monday, February 2, 2026
Kept Companies	jason.krynock@keptcompanies.com	Monday, February 2, 2026
Sample Supplier	erfp@syssoft.com	Tuesday, February 3, 2026
Signdealz	werner@signdealz.com	Tuesday, February 3, 2026
Ruppert Landscape	Phayes@ruppertcompanies.com	Wednesday, February 4, 2026

REPLACEMENT Solicitation Drawing Pages: Cover, LD1.02, LS1.02, LS2.02, LS2.03, and LS2.04 (a separate document “2026C-24 Addendum 1 Attach E”)

Florida State College at Jacksonville is a member of the Florida College System and is not affiliated with any other public or private university or college in Florida or elsewhere.

Florida State College at Jacksonville does not discriminate against any person on the basis of race, disability, color, ethnicity, national origin, religion, gender, age, sex, sexual orientation/expression, marital status, veteran status, pregnancy or genetic information in its programs or activities. Inquiries regarding the non-discrimination policies may be directed to the College's Civil Rights Compliance Office, 501 West State Street, Jacksonville, Florida 32202 | (904) 632-3221 | CRCO@fscj.edu.

Florida State College at Jacksonville is accredited by the Southern Association of Colleges and Schools Commission on Colleges to award the baccalaureate and associate degree. Contact the Commission on Colleges at 1866 Southern Lane, Decatur, Georgia 30033-4097, or call (404) 679-4500 for questions about the accreditation of Florida State College at Jacksonville. The Commission is to be contacted only if there is evidence that appears to support an institution's significant non-compliance with a requirement or standard.

FSCJ South Campus

Signage Hardscape and Landscape Plans

Issue for Bid

OWNER:
Florida State College at Jacksonville
Dale Cason
501 West State Street
Jacksonville, FL 32202
(904) 633-5973

CIVIL ENGINEER:
Prime AE
Matt Melchiori, PE
13901 Sutton Park Drive South, Suite 200
Jacksonville, FL 32224-0229
(904) 739-3655

LANDSCAPE ARCHITECT:
Prime AE
Richard R. Lonergan, RLA
13901 Sutton Park Drive South, Suite 200
Jacksonville, FL 32224-0229
(904) 739-3655

SURVEYOR:
Clary & Associates
Jeff Steinle
3830 Crown Point Rd,
Jacksonville, FL 32257
(904) 260-2703

STRUCTURAL ENGINEER:
Atlantic Engineering Services
Jude Kostage, PE
4141 Southpoint Drive East
Jacksonville, FL 32216
(904) 743-4633

ELECTRICAL ENGINEER:
HADDAD ENGINEERING INC.
Namir Haddad, PE
3030 Hartley Rd, Suite 290
Jacksonville, FL 32257
(904) 262-5066

GEOTECHNICAL SERVICES:
MESKEL & ASSOCIATES ENGINEERING
P. Rodney Mank, PE
3728 Philips Highway, Suite 208
Jacksonville, FL 32207
(904) 519-6990
Geotechnical Report Date 06/10/25



FLORIDA STATE COLLEGE AT JACKSONVILLE SOUTH CAMPUS
11901 BEACH BOULEVARD,
JACKSONVILLE, FLORIDA 32246

SHEET INDEX	
SHEET NUMBER	SHEET TITLE
-	COVER
V1.01	SITE SURVEY
V1.02	SITE SURVEY
V1.03	SITE SURVEY
LS0.01	OVERALL SITE PLAN, GENERAL NOTES AND LEGEND
LD1.01	LANDSCAPE DEMO PLAN
LD1.02	LANDSCAPE DEMO PLAN
LS1.01	LANDSCAPE SITE PLAN
LS1.02	LANDSCAPE SITE PLAN
LS2.01	LANDSCAPE SITE DETAILS
LS2.02	LANDSCAPE SITE DETAILS
LS2.03	LANDSCAPE SITE DETAILS
LS2.04	LANDSCAPE SITE & VEHICULAR SIGN DETAILS
S0.01	GENERAL NOTES
S1.01	PRIMARY ENTRY SIGN
S1.02	SECONDARY ENTRY SIGN
E1.0	OVERALL SITE PLAN GENERAL NOTES AND LEGEND
E1.1	LIGHTING SITE PLAN
E1.2	ELECTRICAL SITE PLAN
E1.3	ELECTRICAL SITE PLAN
E2.0	ELECTRICAL SPECIFICATIONS
LP0.01	LANDSCAPE GENERAL NOTES, PLANTING SCHEDULE & COJ CALCULATIONS
LP1.01	LANDSCAPE PLANTING PLAN
LP1.02	LANDSCAPE PLANTING PLAN
LP2.01	LANDSCAPE PLANTING DETAILS
LP2.02	LANDSCAPE PLANTING SPECIFICATIONS
LP2.03	LANDSCAPE MAINTENANCE SPECIFICATIONS
IR0.01	IRRIGATION INDEX, NOTES & LEGEND
IR1.01	IRRIGATION SOURCE PLAN
IR1.02	IRRIGATION SOURCE PLAN
IR2.01	IRRIGATION DETAILS
IR2.02	IRRIGATION SPECIFICATIONS

ISSUED January 16, 2026

No.	Date	Revision
	01.16.2026	ISSUE FOR BID
1	02.04.2026	ADDENDUM #1

Prosser Inc. No. 123033.03

SOUTH CAMPUS SIGNAGE

SSUE FOR BID

DATE : 01.16.26
PROJECT NO. : 125038.01
DESIGNED BY : SRB
DRAWN BY : RRL
SCALE : AS NOTED

[illegible]

THIS DRAWING NOT RELEASED FOR
CONSTRUCTION UNLESS SO NOTED ABOVE

SHEET TITLE

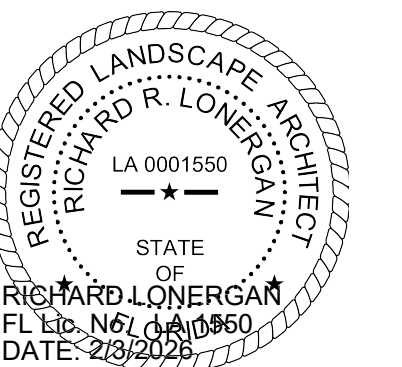
LANDSCAPE DEMO
PLAN

D1.02

S H E E T

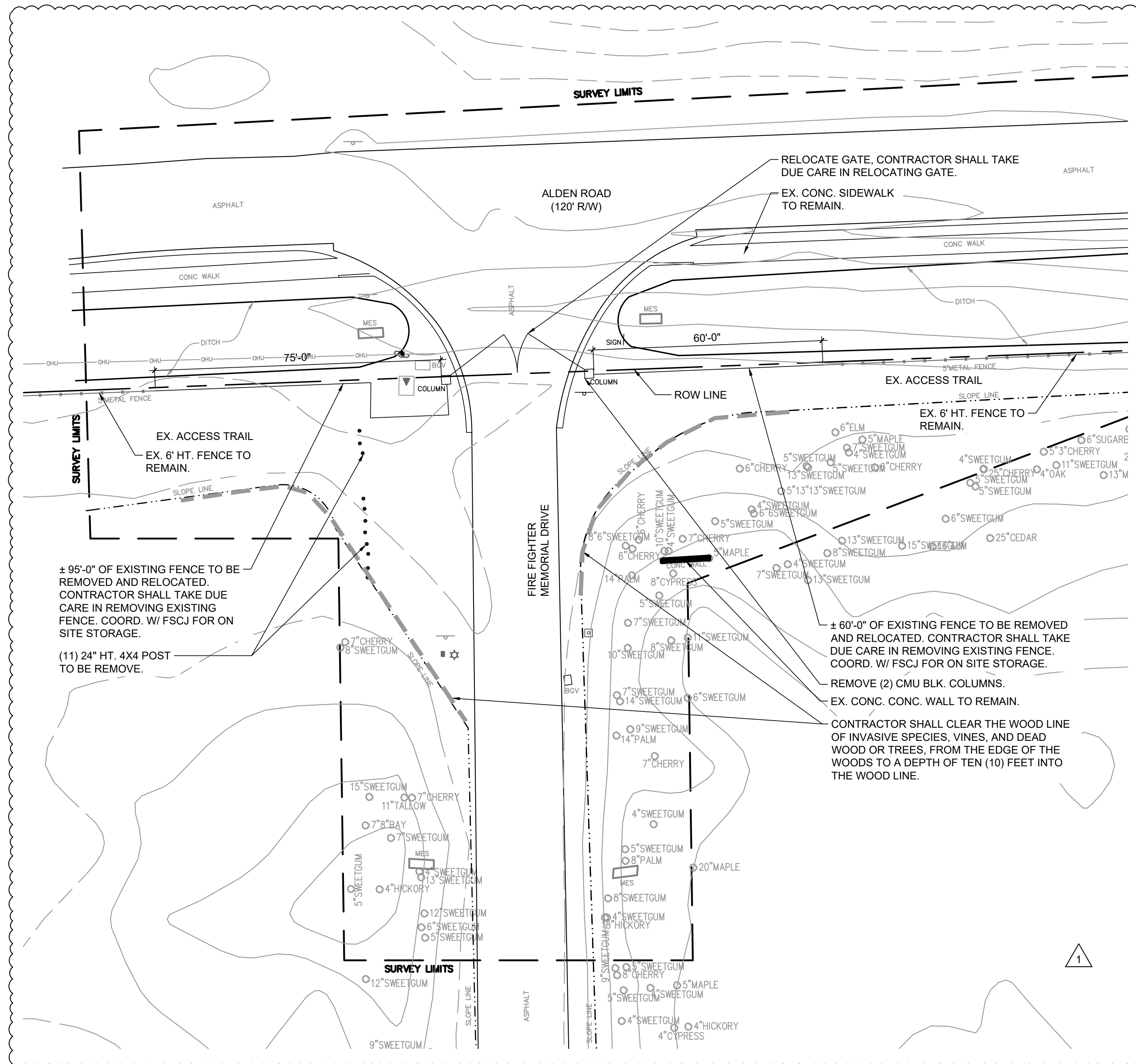

2

Secondary Entry at Alden Road

Scale: 1" = 20'-0"



A horizontal number line with tick marks at -20, 0, and 20. The line is divided into four equal segments by these tick marks. The segments are colored alternately: black, white, black, and white from left to right.

(1

Secondary Entry at Huffman Road

Scale: 1" = 20'-0"



SOUTH CAMPUS SIGNAGE

SSUE FOR BID

DATE : 01.16.26
PROJECT NO. : 125038.01
DESIGNED BY : SRB
DRAWN BY : RRL
SCALE : AS NOTED

[illegible]

THIS DRAWING NOT RELEASED FOR
CONSTRUCTION UNLESS SO NOTED ABOVE

SHEET TITLE

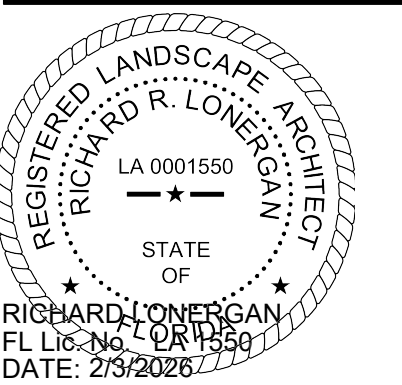
LANDSCAPE SITE
PLAN

S1.02

S H E E T

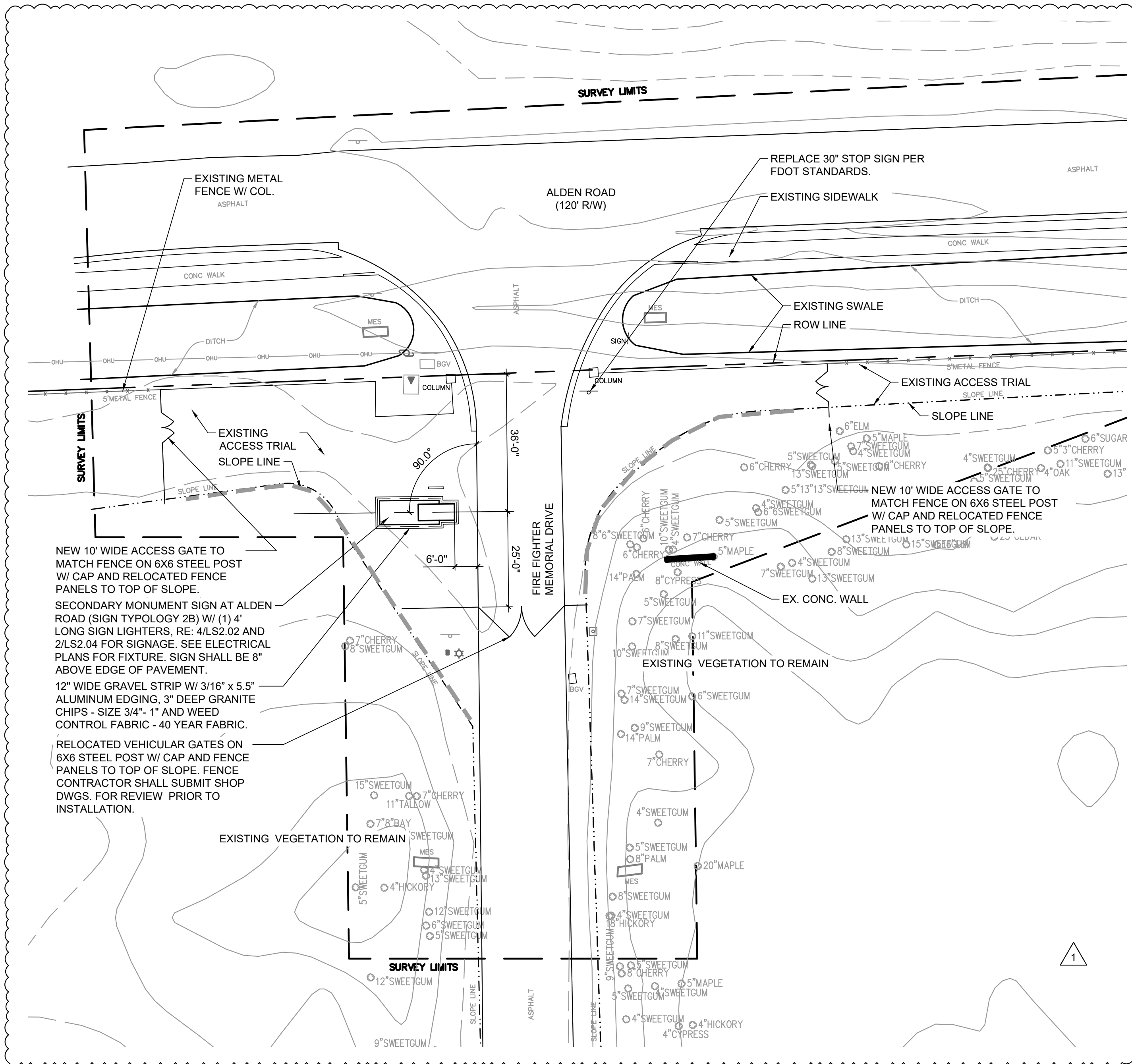

NOTE:

1. UTILITIES MAY BE LOCATED WITHIN THE PROJECT AREA THAT AREA NOT SHOWN ON THIS PLAN.
2. CONTRACTOR TO VERIFY LOCATION OF ANY EXISTING UTILITIES WITHIN PROJECT AREA AND COORD. W/ CIVIL AND LANDSCAPE ARCHITECT PRIOR TO CONSTRUCTION ACTIVITIES.
3. FOR MAINTENANCE OF TRAFFIC (MOT) THE CONTRACTOR SHALL PROVIDE A M.O.T. PLAN UTILIZING THE FDOT STANDARDS PLANS INDEX 102-600, 102-601, 102-602, AND FOR ALL SIDEWALK CLOSURES UTILIZE FDOT STANDARDS PLANS INDEX 102-660.
4. A SAFETY PLAN WITH TWO LAYERS OF BARRICADES SHALL BE PROVIDED BY THE CONTRACTOR AS STATED IN THE STATE REQUIREMENTS FOR EDUCATIONAL FACILITIES (SREF) & THE FLORIDA BUILDING CODE.
5. ALL EXISTING SOD AREAS DISTURBED DURING CONSTRUCTION UNDER THESE PLANS SHALL BE REGRADED AND RESODDED. THE SOD TYPE SHALL MATCH THE EXISTING SOD REMOVED DUE TO CONSTRUCTION.

2

Secondary Entry at Alden Road (Sign Typology 2B)

Scale: 1" = 20'-0"

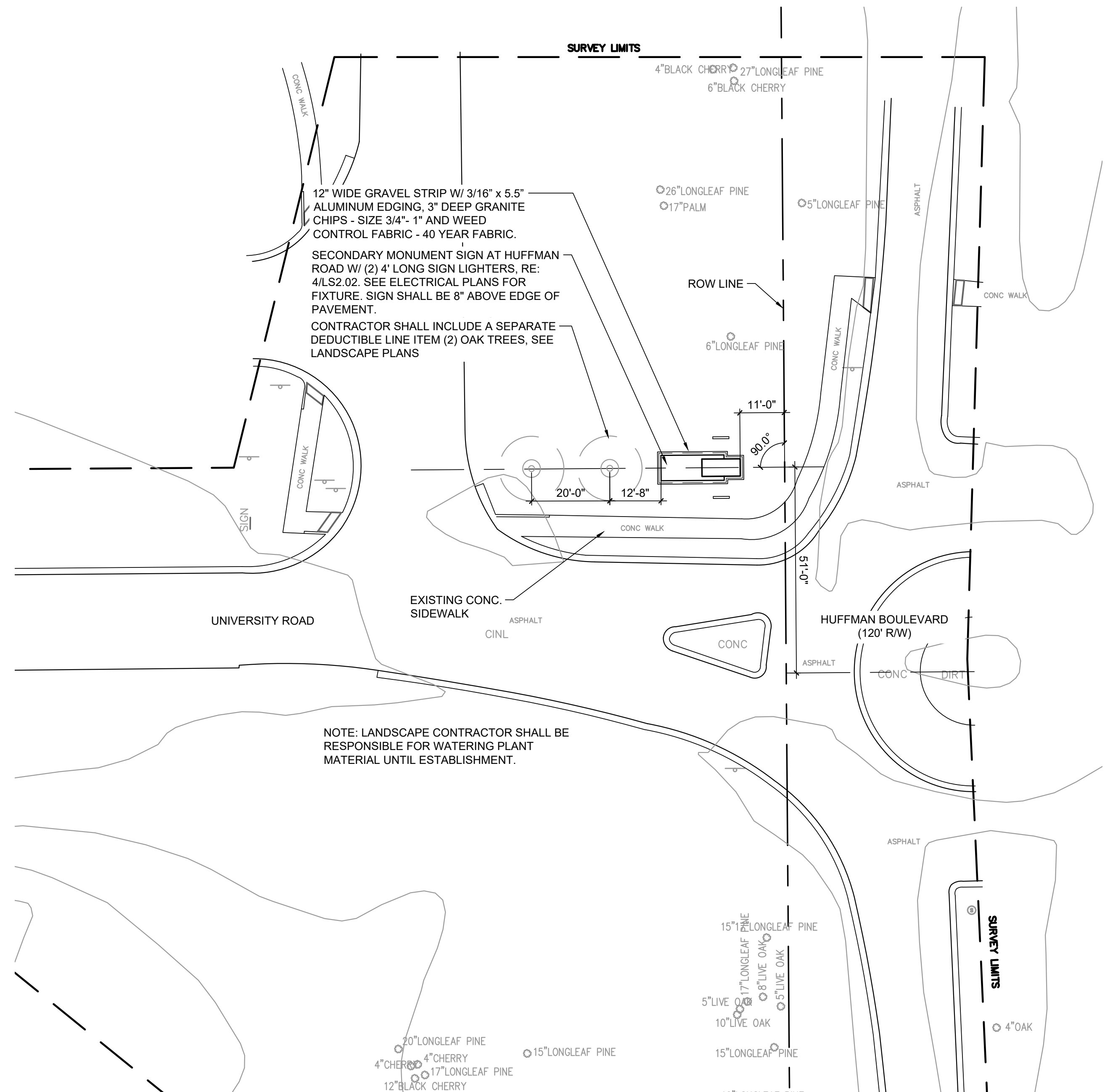

NOTE:

1. UTILITIES MAY BE LOCATED WITHIN THE PROJECT AREA THAT AREA NOT SHOWN ON THIS PLAN.
2. CONTRACTOR TO VERIFY LOCATION OF ANY EXISTING UTILITIES WITHIN PROJECT AREA AND COORD. W/ CIVIL AND LANDSCAPE ARCHITECT PRIOR TO CONSTRUCTION ACTIVITIES.
3. FOR MAINTENANCE OF TRAFFIC (MOT) THE CONTRACTOR SHALL PROVIDE A M.O.T. PLAN UTILIZING THE FDOT STANDARDS PLANS INDEX 102-600, 102-601, 102-602, AND FOR ALL SIDEWALK CLOSURES UTILIZE FDOT STANDARDS PLANS INDEX 102-660.
4. A SAFETY PLAN WITH TWO LAYERS OF BARRICADES SHALL BE PROVIDED BY THE CONTRACTOR AS STATED IN THE STATE REQUIREMENTS FOR EDUCATIONAL FACILITIES (SREF) & THE FLORIDA BUILDING CODE.
5. ALL EXISTING SOD AREAS DISTURBED DURING CONSTRUCTION UNDER THESE PLANS SHALL BE REGRADED AND RESODDED. THE SOD TYPE SHALL MATCH THE EXISTING SOD REMOVED DUE TO CONSTRUCTION.

1

Secondary Entry at Huffman Road (Sign Typology 2A)

Scale: 1" = 20'-0"



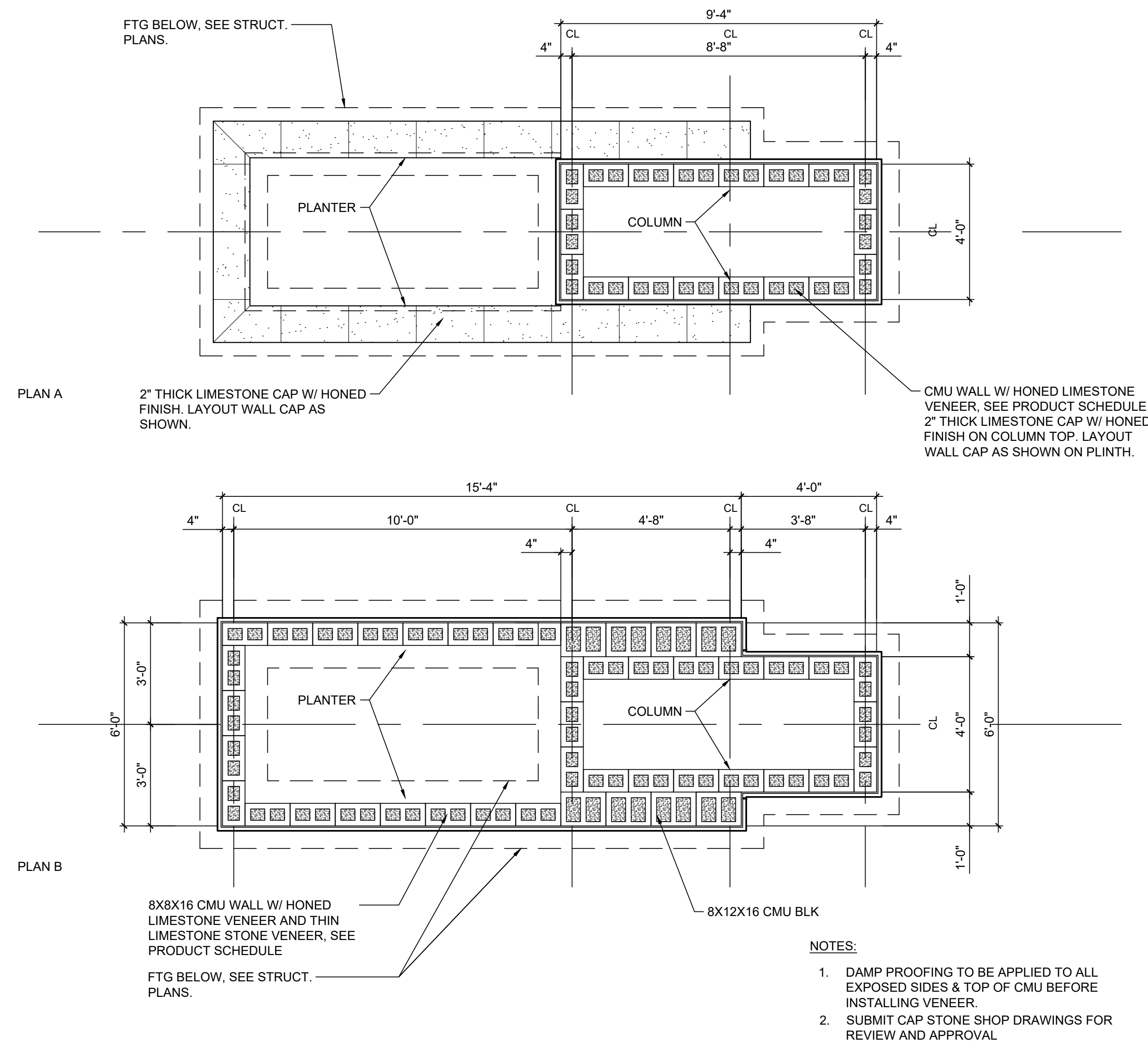
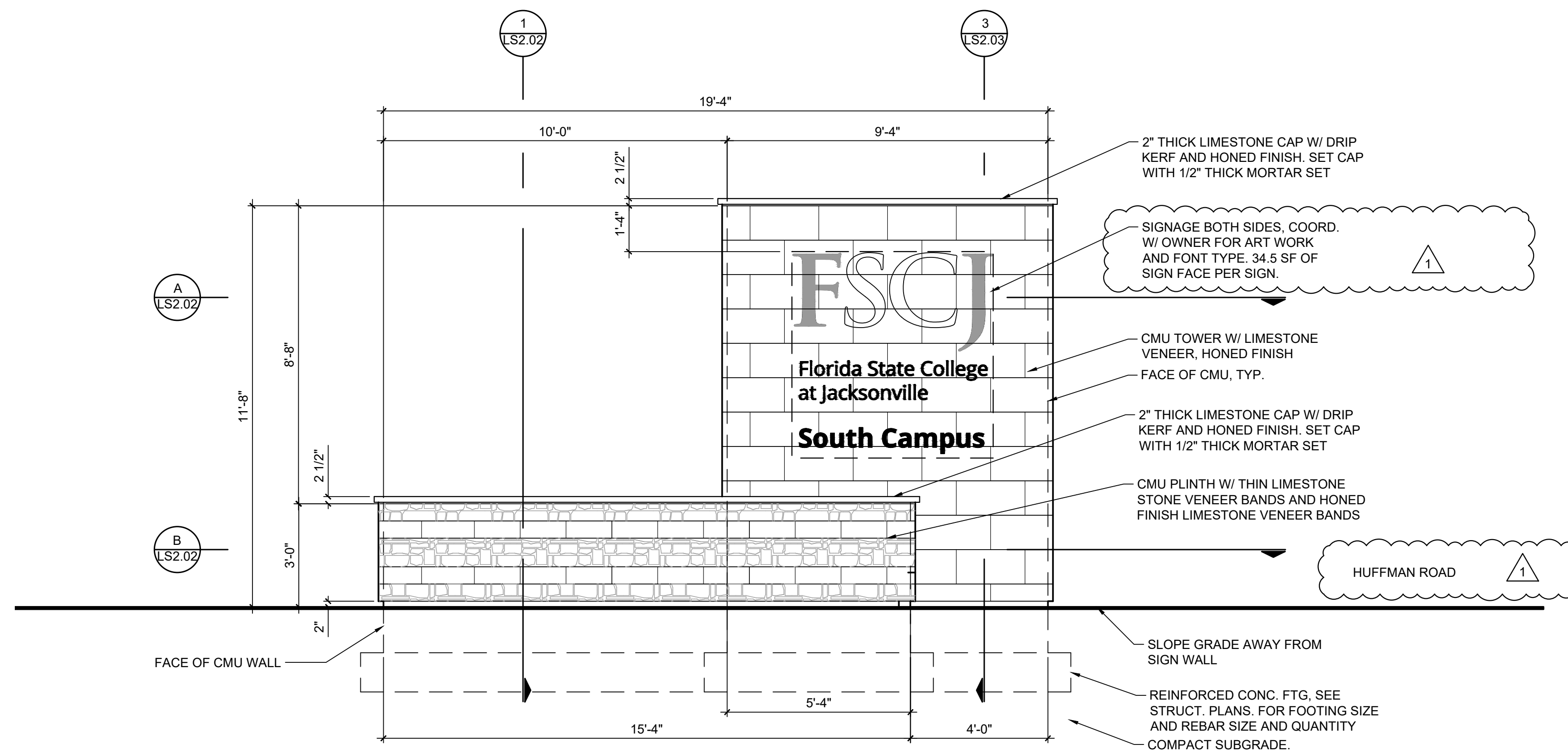

4 Secondary I.D. Sign (Sign Typology 2A) Elevation and Cross Sections
Scale: 3/8" = 1'-0"

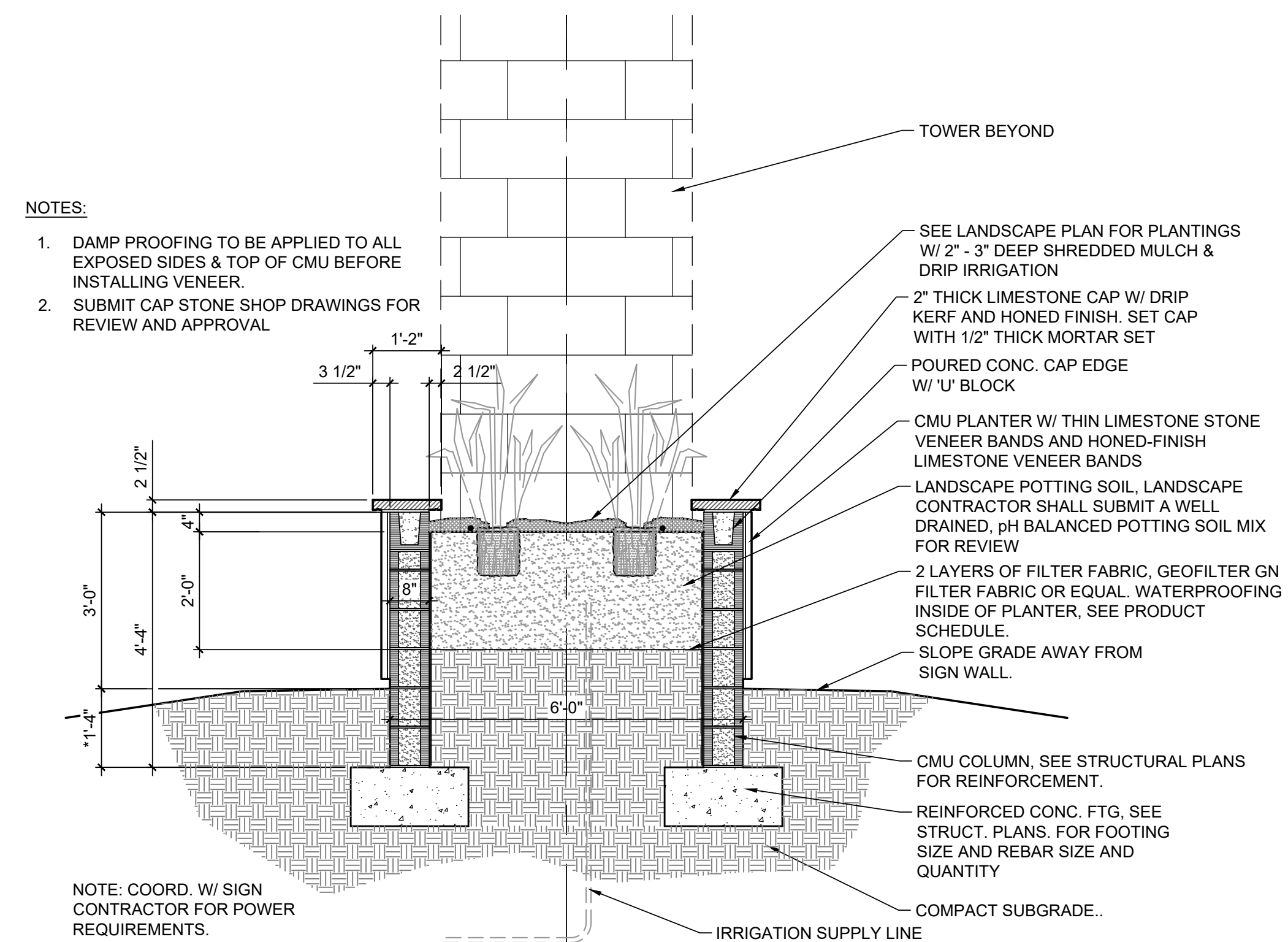

1 Entry Monument Sign (Typology 1 & 2A) Low Planter Wall Section
Scale: 1/2" = 1'-0"

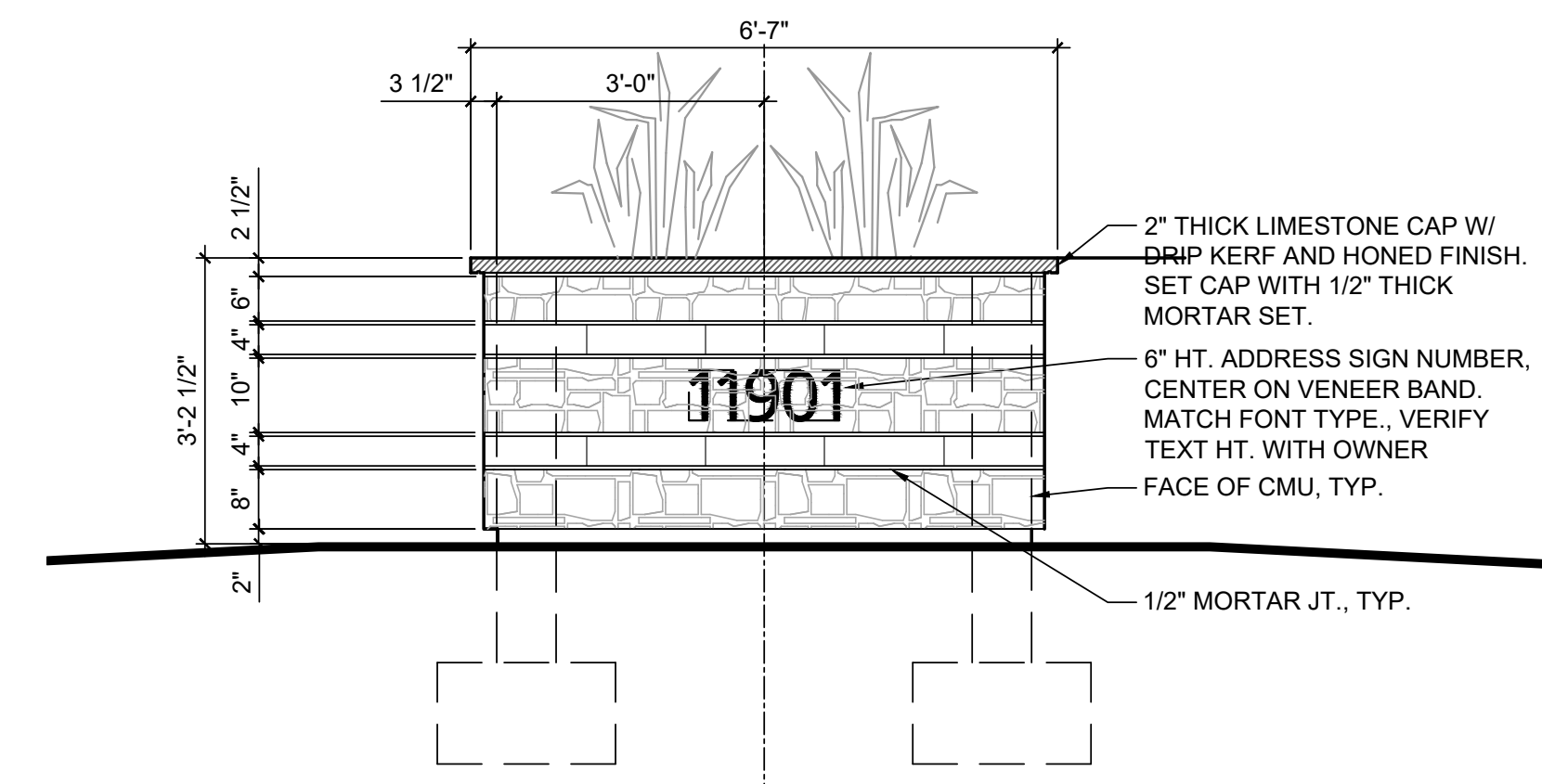

2 Landscape Median Low Planter Wall (Typology 1) Elevation

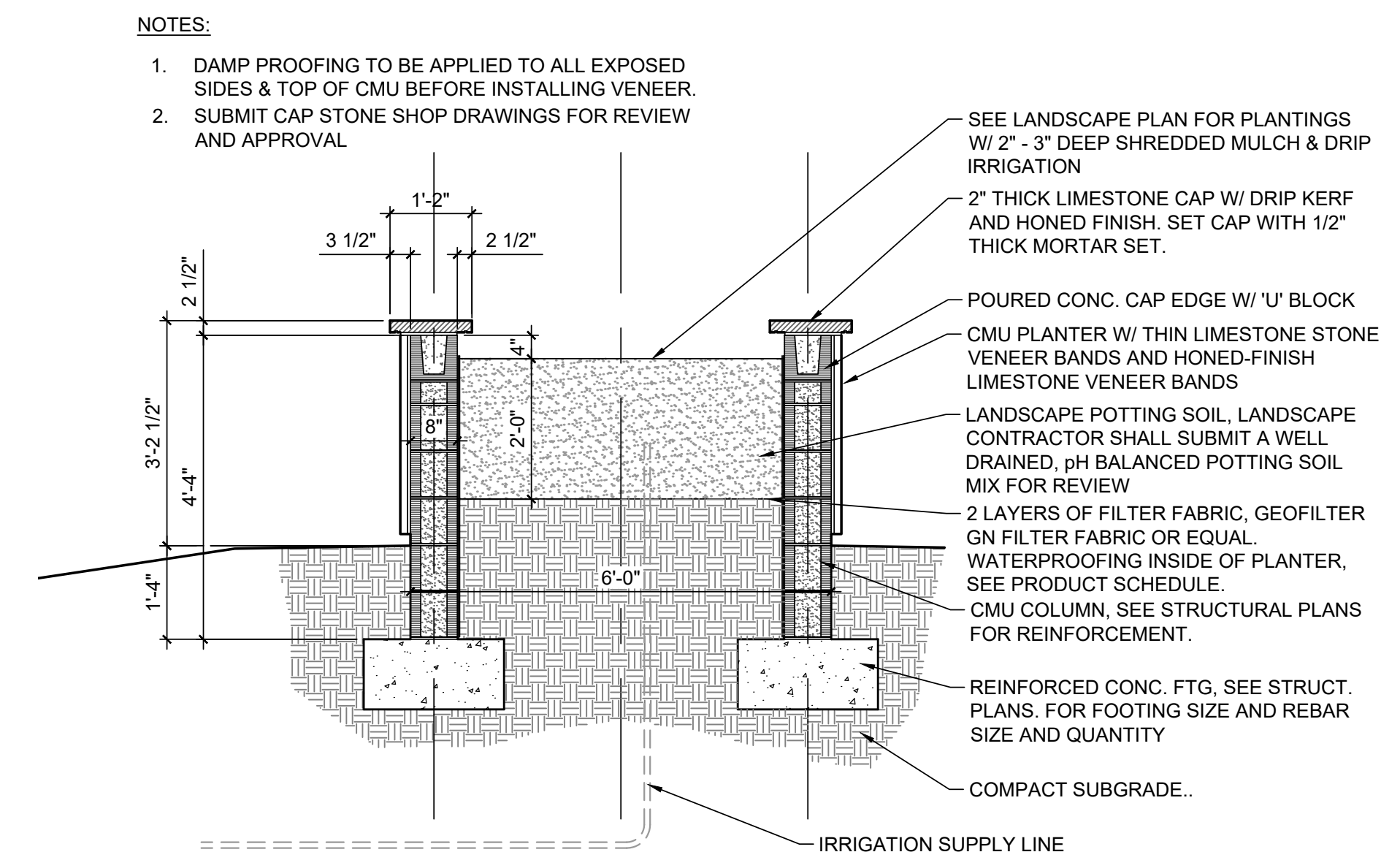

3 Landscape Median Low Planter Wall (Typology 1) Section
Scale: 1/2" = 1'-0"

[illegible]

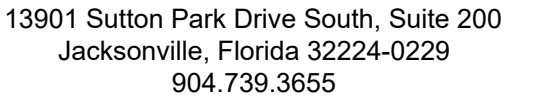

FSCJ

Florida State College
Jacksonville

SOUTH CAMPUS SIGNAGE

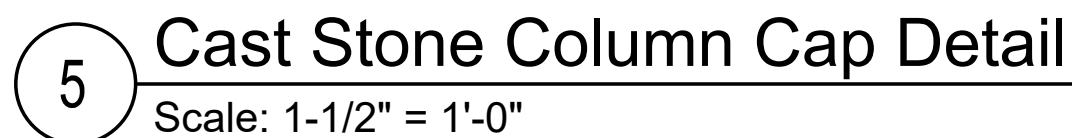
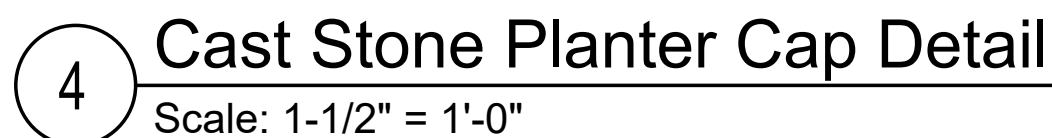

DATE : 01.16.26
PROJECT NO. : 125038.01
DESIGNED BY : SRB
DRAWN BY : RRL
SCALE : AS NOTED

THIS DRAWING NOT RELEASED FOR
CONSTRUCTION UNLESS SO NOTED ABOVE

SHEET TITLE

LANDSCAPE SITE DETAILS

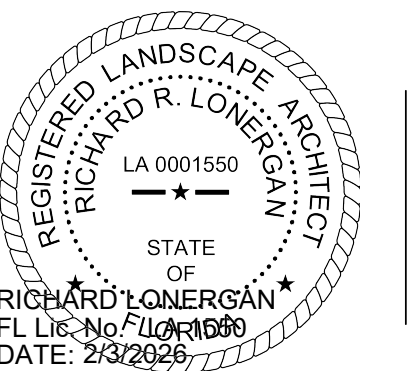

S2.03

SHEET

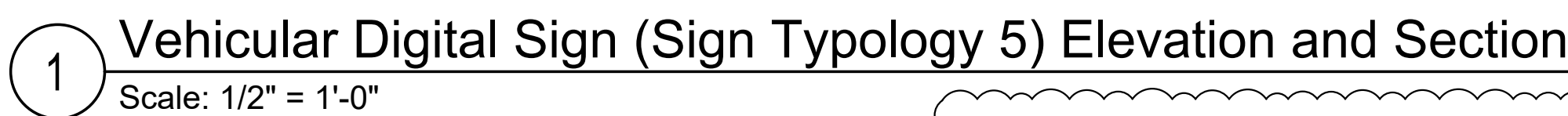
S H E E T